

(CRONA2.CNX) 17005

# CORONA TWO DEPARTURE (OBSTACLE)

ALAMOGORDO-WHITE SANDS RGNL (A.I.M)  
SL-5130 (FAA) ALAMOGORDO, NEW MEXICO

ALBUQUERQUE CENTER  
132.65 257.6  
HOLLOMAN DEP CON\*  
128.1 284.0  
UNICOM  
122.8  
AWOS-3  
127.825

CORONA  
115.5 CNX  
Chan 102  
N34°22.02'  
W105°40.68'  
L-6, H-4-6

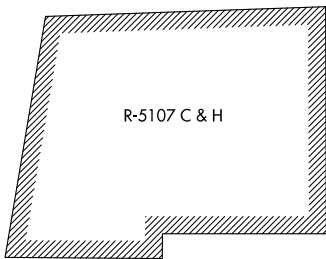

R-5107 C & H

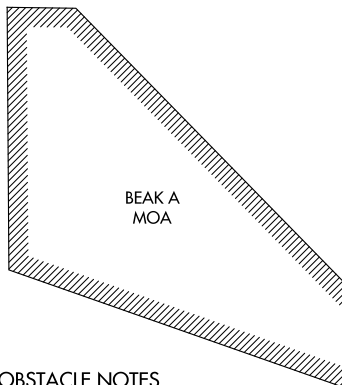

BEAK A  
MOA

CORAS  
N33°40.34'  
W105°58.66'  
14000

TRUTH OR CONSEQUENCES  
112.7 TCS  
Chan 74

### TAKEOFF OBSTACLE NOTES

Rwy 4: Tree 150' from DER 440' right of centerline 4207' MSL.  
Trees beginning 175' from DER, 475' left of centerline, up to 4208' MSL.  
Tree 326' from DER 585' left of centerline 4209' MSL.  
Pole 1018' from DER 694' left of centerline 51' AGL/4258' MSL.  
Pole 1343' from DER 659' left of centerline 51' AGL/4260' MSL.

### TAKEOFF MINIMUMS

Rwy 4: Standard with minimum climb of 240' per NM to 4600.  
Rwys 17, 35: NA-Environmental  
Rwy 22: NA-Airspace.

BOLES  
109.6 BWS  
Chan 33

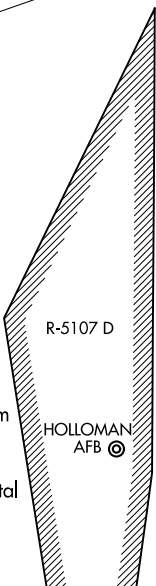

R-5107 D

HOLLOMAN  
AFB

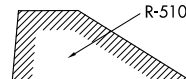

R-5103 B & C

NOTE: Chart not to scale.

### DEPARTURE ROUTE DESCRIPTION

**TAKEOFF RUNWAY 4:** Climbing left turn heading 310° to intercept BWS VOR/DME R-354 northbound. Cross CORAS at 14000, then right turn on CNX VORTAC R-187 to CNX VORTAC.

CORONA TWO DEPARTURE (OBSTACLE)  
(CRONA2.CNX) 05JAN17

ALAMOGORDO, NEW MEXICO  
ALAMOGORDO-WHITE SANDS RGNL (A.I.M)

SW-1, 19 JUL 2018 to 16 AUG 2018

SW-1, 19 JUL 2018 to 16 AUG 2018